

## REDUCED TEE 90°

03 Update - 05/2024

### TECHNICAL DATA

Article No	001 117 0042 0258
d1 (mm)	250
d2 (mm)	90
L (mm)	590
le1 (mm)	135
le2 (mm)	83
Z (mm)	243
s1 (mm)	22,7
s2 (mm)	8,2
Weight (Kg)	11,510
Box Quantity (pcs)	1
Box Dimension (pcs)	36x60x46,5

### INJECTION MOULDED

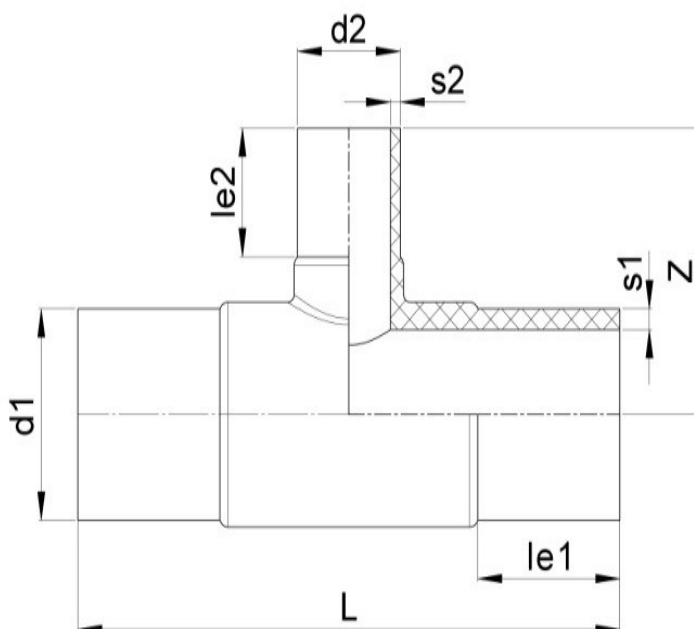

### IDENTIFICATION OF PRODUCT

D(mm)	250-90
SDR	11
RAW METARIAL	PE 100
PRESSURE CLASS	16 Bar Water 10 Bar Gas
TRADEMARK	NTG
EXECUTION	Injection Moulded
STANDARD	EN 12201-3 EN 1555-3 AS /NZS 4129

### SPECIFICATION

Long Spigot

Tolerance on diameters and thickness according to the standards. The other dimensions are specialized. Tolerance  $\pm 5\%$ . NTG PLASTIK reserves all the right to change any information without giving prior notice. The production, distribution and utilization of this document without explicit authorization is prohibited.